

# Appendix 2

NOTES  
 THE CONTRACTOR IS RESPONSIBLE FOR CHECKING ALL DIMENSIONS AND NOTIFYING ALL DISCREPANCIES TO THE DESIGNER.  
 USE FIGURED DIMENSIONS IN PREFERENCE TO SCALED DIMENSIONS.  
 ALL WORK TO BE IN ACCORDANCE WITH CURRENT BUILDING REGULATIONS.  
 COPYRIGHT OF THIS DRAWING IS RESERVED BY G.I.A. LIMITED, AND IS ISSUED ON THE CONDITION THAT IT IS NOT COPIED, REPRODUCED OR DISCLOSED TO ANY THIRD PARTY EITHER WHOLLY OR IN PART WITHOUT THE CONSENT IN WRITING OF G.I.A. LIMITED.

Line of Demise  
 340 PERSON OCCUPANCY

SPRINKLER SYSTEM TO BE DESIGNED AND INSTALLED BY SPECIALIST CONTRACTOR

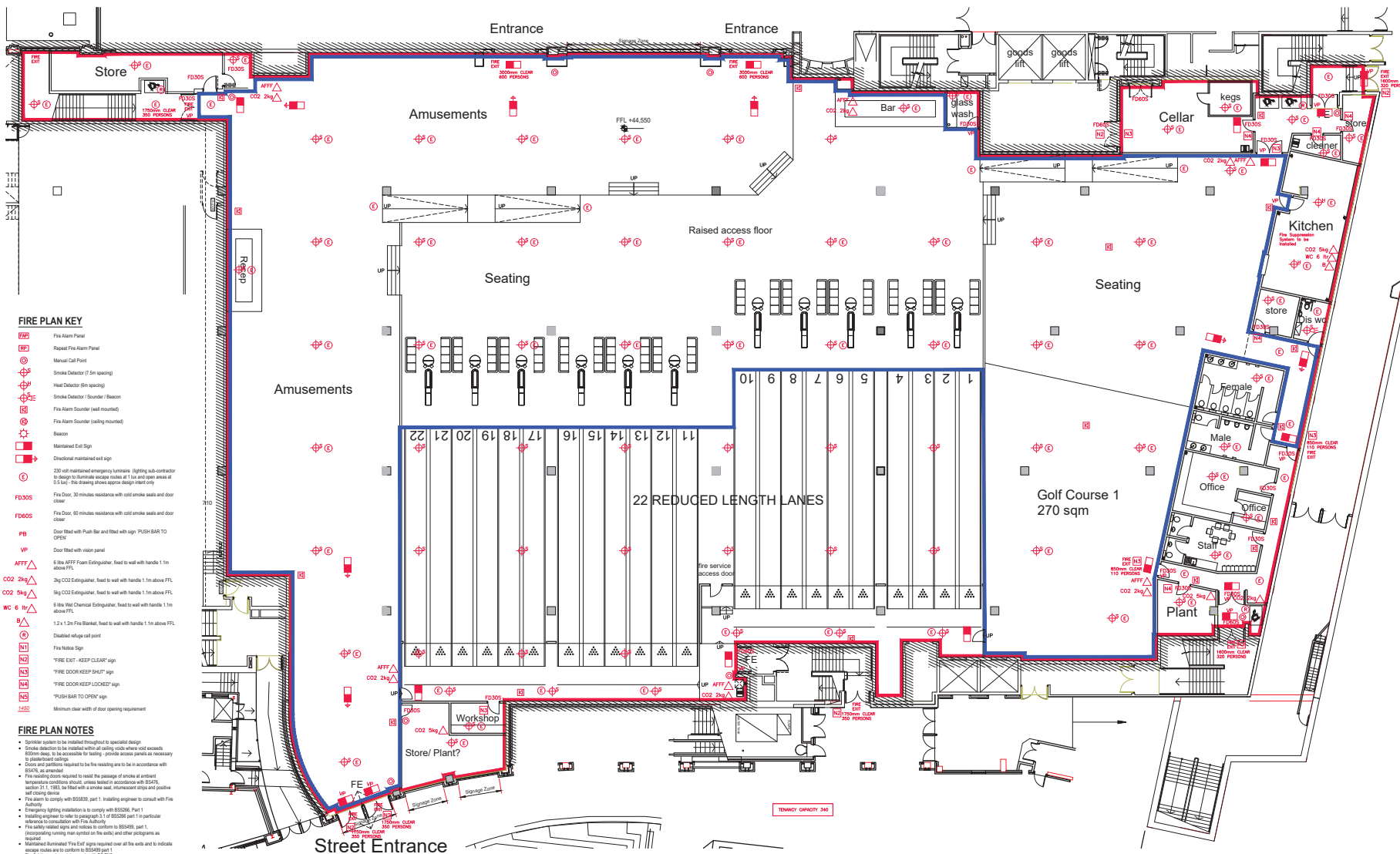

- FIRE PLAN KEY**
- Fire Alarm Panel
  - Repeat Fire Alarm Panel
  - Manual Call Point
  - Smoke Detector (7.5m spacing)
  - Heat Detector (6m spacing)
  - Smoke Detector / Beacon
  - Fire Alarm Sounder (wall mounted)
  - Fire Alarm Sounder (ceiling mounted)
  - Beacon
  - Maintained Exit Sign
  - Directional maintained exit sign
  - 200 volt maintained emergency luminaire (lighting sub-contractor to design to terminate smoke inside at 1.5m and open view at 0.5 m) - this drawing shows approx design intent only
  - FD30S Fire Door, 30 minutes resistance with cold smoke seals and door closer
  - FD60S Fire Door, 60 minutes resistance with cold smoke seals and door closer
  - PB Door fitted with Push Bar and fitted with sign 'PUSH BAR TO OPEN'
  - VP Door fitted with vision panel
  - AF77 6 litre AFFF Foam Extinguisher, fixed to wall with handle 1.1m above FFL
  - CO2 2kg 2kg CO2 Extinguisher, fixed to wall with handle 1.1m above FFL
  - CO2 5kg 5kg CO2 Extinguisher, fixed to wall with handle 1.1m above FFL
  - WC 6 litre 1.2 x 1.2m Fire Blanket, fixed to wall with handle 1.1m above FFL
  - Disabled refuge call point
  - Fire Notice Sign
  - 'FIRE EXIT - KEEP CLEAR' sign
  - 'FIRE DOOR KEEP SHUT' sign
  - 'FIRE DOOR KEEP LOCKED' sign
  - 'PUSH BAR TO OPEN' sign
  - Minimum clear width of door opening requirement

- FIRE PLAN NOTES**
- Sprinkler system to be installed throughout to specialist design
  - Smoke detection to be installed within all ceiling voids where cold smoke is to clear voids, to be responsible for testing - provide access panels as necessary to permit testing
  - Doors and partitions required to be fire resisting and to be in accordance with BS278, as amended
  - Fire resisting doors required to resist the passage of smoke at ambient temperature conditions unless stated in accordance with BS476, section 31.1, 1993, to be fitted with a smoke seal, intumescent strips and positive self-closing device
  - Fire alarm to comply with BS5839, part 1, installing engineer to consult with Fire Authority
  - Emergency lighting installation to be in compliance with BS5266, Part 1, installing engineer to refer to paragraph 3.1 of BS5266 part 1 in particular reference to compliance with fire authority
  - Fire safety notices signs and notices to conform to BS4849, part 1, incorporating warning message on the wall and other pictograms as required
  - Maintained luminaire/Call Call signs required over all fire exits and to indicate escape routes and to conform to BS5489 part 1
  - Fire fighting equipment to comply with BS5443
  - Upstanded lighting fixtures to satisfy as minimum stipulated ignition source 2 and Call point source as specified in BS5266, CO2E, clause 11, without a test assessment of the integrity of upstanded ceiling by unobstructed and flaming ignition source
  - Carrels and other traffic hangings must be inherently flame retardant or be treated with a suitable flame retardant. This must be specified in compliance with the type performance requirements of BS2027, part 2, 1980 - specification for fabric for curtains and drapes - flame retardant requirements
  - Table fire coverings should be treated to BS2027, part 2, 1980 - specification for fabric for curtains and drapes - flame retardant requirements
  - Table fire coverings should be treated to BS2027, part 2, 1980 - specification for fabric for curtains and drapes - flame retardant requirements
  - Artificial foliage and other decorative effects are to be fire retardant to the satisfaction of the Fire Authority
  - Wall and ceiling linings are to be class 1 surface spread of flame (as described in BS476, Part 1) in public areas, Class 0 in escape routes
  - Test certificates should be provided in respect of Fire alarm, Emergency lighting, maintained exit signs, luminaires and call points
  - All fire doors fire resisting compartment walls to be provided with minimum of three self-closing doors to the top of the wall at floor level
  - All voids in floor, ceiling and walls, including voids in duct walls, to be left to the 200 maximum height to eliminate production of the barriers suitable for the purpose - submit proposals to CA for approval prior to ordering

NOTE FIRE EQUIPMENT/FIRE PRECAUTIONS TO LANDLORD'S AREAS OUTSIDE OF TENANT'S DEMISE NOT SHOWN - SEE LANDLORD'S DETAILS

- LICENSING LEGEND**
- EXTENT OF LICENCED PREMISES
  - THOSE AREAS OF THE PREMISES TO BE USED FOR LICENSABLE ACTIVITIES
  - SEE LANDLORD'S OTHER DRAWINGS FOR DETAILS OF FIRE RESISTANCE OUTSIDE THE LINE OF DEMISE

REV	DESCRIPTION	DATE
AMENDMENTS		
CLIENT		
THE ORIGINAL BOWLING COMPANY		
JOB		
HOLLYWOOD BOWL, THE CHIMES, UXBRIDGE		
DRAWING		
UPPER MALL LICENSING PLAN		
JOB NO.	2954-01	DRAWING NO.
SCALE		301
1:150 @ A1		
DRAWN BY		DATE
		Dec 23



G.I.A. LTD, 3 Foxes Park, Common Road, Dunmurry, York, W19 9SE.  
 T 01904 481 480 F 01904 486 730 e design@gia.co.uk www.gia.co.uk  
 INCORPORATED IN IRELAND REG NO 27418